

## Low Profile Mobile Antenna Mount with Toggle Joint

### DESCRIPTION

- Can be used together with all Amphenol Procom mobile antenna whips provided with toggle joint.
- Installation possible everywhere on the car.
- Particularly well suited for rooftop-mounting because of very low internal protrusion and ability to be installed exclusively with access from the outside. Models with roof thickness from 2 mm to 7.5 mm mounting from the inside.
- Hole diameter: 21 mm.
- Mounting body made of stainless steel !
- Wide variety of antenna whips available in the frequency range up to 470 MHz.
- Choice between two connection principles:
  - Z-mount : FME-connection (supplied without cable).
  - ZP4-mount : Permanently attached 4 m cable terminated with FME-connector.
  - ECE R118.02 approved cable.
- Available in bright or black (black plastic parts for both versions).



### SPECIFICATIONS

Electrical	
Model	Z-Mount
Frequency	0 - 470 MHz
Application	Low-profile mount for mobile antennas
Mechanical	
Installation Diameter	38 mm / 1.50 in.
Build-In Depth	10.5 mm
Materials	Stainless steel Bright or black chromed brass Weather- and shockproof plastics
Installation Torque	7.5 ± 1 Nm
Colour	Black or bright and black
Whip Connection	Toggle joint (for wing screw or hat screw with key)
Height	Approx. 40 mm / 1.57 in.
Weight	Z-version: Approx. 90 g / 0.19 lb. ZP4-version: Approx. 230 g / 0.51 lb.
Mounting	21 mm dia. hole (For roof thicknesses 2 mm up to 7.5 mm mounting hole should be 22 mm dia.)
Mounting Plate Thickness	Max. 2.0 mm (Models up to 7.5 mm on request)

## ORDERING

Model	Product No.	Description
Z-Mount	130000396	Z-mount (bright) with FME-system
BZ-Mount	130000398	BZ-mount (black) with FME-system
ZP4-Mount	130000410	ZP4-mount (bright) with 4 m cable and FME-connector
BZP4-Mount	130000412	BZP4-mount (black) with 4 m cable and FME-connector
ZP5	130000411	ZP5-mount (bright) with 5 m cable and FME-connector
BZP5-Mount	130000408	BZP5-mount (black) with 5 m cable and FME-connector
<b>Accessories - Roof Thickness</b>		
Z-Mounting Adaptor	130002393	2 - 5 mm
Z-Mounting Adaptor	130002394	5 - 7.5 mm
<b>Accessories - FME-Cables</b>		
1 m FME(f) to FME(f) cable	130000437	
2 m FME(f) to FME(f) cable	130000447	
3 m FME(f) to FME(f) cable	130000457	
4 m FME(f) to FME(f) cable	130000466	
5 m FME(f) to FME(f) cable	130000474	
6 m FME(f) to FME(f) cable	130000483	
4 m FME(f) to FME(f) cable, white	110000064	
6 m FME(f) to FME(f) cable, white	110000066	
12 m FME(f) to FME(f) cable, white	110000068	
18 m FME(f) to FME(f) cable, white	110000069	
<b>Accessories - FME-Connectors</b>		
FME(f)-FME(f) Connector Adaptor	130000583	
FME(m)-P(m) (Prolongation) Connector Adaptor	130000565	
FME(m)-N(m) Connector Adaptor	130000571	
FME(m)-SMA(f) Connector Adaptor	130000578	
FME(m)-BNC(m) Connector Adaptor	130000566	
FME(m)-TNC(m) Connector Adaptor	130000569	
FME(m)-UHF(m) Connector Adaptor	130000572	
FME(m)-MiniUHF(m) Connector Adaptor	130000573	
FME(m)-MiniUHF(m)(Elbow) Connector Adaptor	130000582	
FME(m)-BNC(m)(Elbow) Connector Adaptor	130000580	
FME(m)-TNC(m)(Elbow) Connector Adaptor	130000581	
FME(m)-SMA(m) Connector Adaptor	130000577	

## FME-SYSTEM ACCESSORIES - NOTE

For further information about other types of FME-cables and FME-connectors, please compare the cable and connector data sheets under accessories in our catalogue.

## INSTALLATION

The Z-mount is designed for mounting in a 21 mm dia. hole.

The whip is fastened to the mount by means of our standard ball joint and wing screw system. The adjustable ball joint ensures that the whip can always be mounted in a vertical position independent of the angle of the installation spot.

The Z-mount is particularly well suited for mounting on car roofs because of its ability to be installed exclusively with access from the outside. The Z-mount for roof thickness from 2 mm to 7.5 mm must be mounted from the inside.

However, the antenna can be installed anywhere on the car, as the Z-mount is equally well suited for mounting on e.g. trunk or wing.

A good contact surface on the inside of the car body must always be ensured, thus enabling the base plate to get in direct contact with the metal parts of the car, which is of utmost importance for proper performance of the antenna.

## 1. INSTALLATION DIMENSIONS

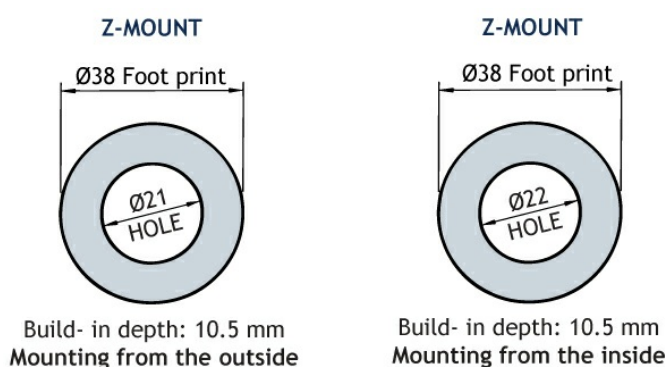

## 2. INSTALLATION STEP

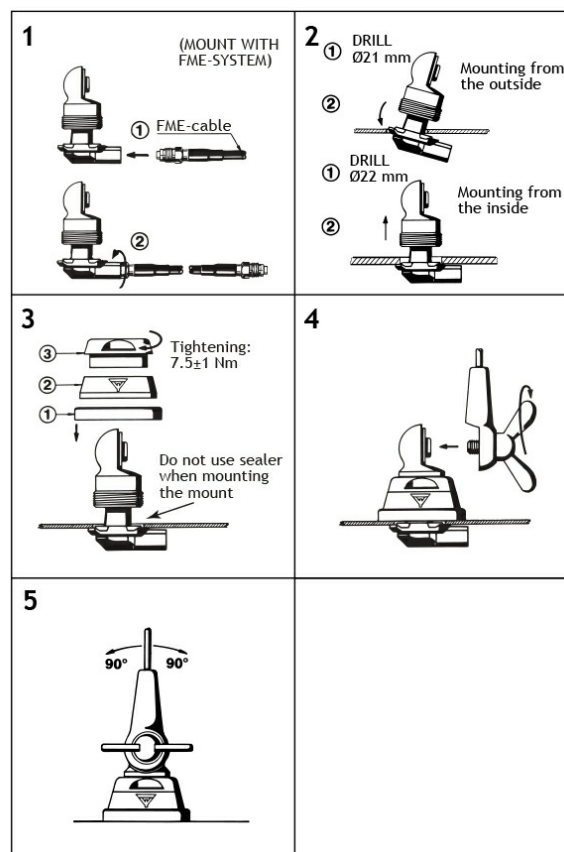

Do not use sealer on rubber gasket or other places.

## PLEASE NOTE

The whips are normally installed on the mount by means of the standard wing screw, but may also be installed using the optional hat screw with key (accessory item).

## DIMENSIONS

