



**MOTOROLA**

**RLN4780**

**Remote Mount Kit**  
(excluding Cable Kit)

© 2002 by Motorola, Inc.  
Radio Products Group  
Jays Close, Viabes Industrial Estate,  
Basingstoke, Hampshire RG22 4PD United Kingdom

Ⓜ and Motorola are registered trademarks of Motorola Inc.  
Professional Radio and GM are trademarks of Motorola Inc.  
All Rights Reserved.



**Professional Radio**



6864119B23-A

Accessories

## Remote Mount Controlhead Installation

**CAUTION:** The radio must be disconnected from the power supply before commencing any disassembly.  
 For installation in environments where water or dust are present, the Remote Mount must be mounted with the speaker grill facing down.  
 The Installation Manual should be referred to for more detailed information on warnings and safety.



### To Disassemble the Radio from the Controlhead

1. Remove the Controlhead from the Transceiver by inserting the dismantling tool in the recess between the Controlhead and the Transceiver.
2. Split the Controlhead into Front and Back housings by inserting the dismantling tool in the recess between them.

**NOTE** 1. To minimise cosmetic damage disassemble from the bottom side, (label side).  
 2. The flex and Controlhead Back Housing are not required for remote mounting.

3. Remove the flex.

### To Assemble the Remote Front Housing:

1. Connect the flex from the Remote Front Housing to the top small connector in the Transceiver.

**NOTE** For correct orientation of the flex in the Transceiver, the "plastic" tab should be up, contacts facing down. Align the 'O' on the flex with the 'O' on the Transceiver. The flex must be pushed into the connector until it meets the stop.

2. Press the Remote Front Housing onto the Transceiver chassis until the 4 chassis tabs snap into place.

### To Assemble the Remote Back Housing

1. Connect the flex from the Remote Back PCB to the Controlhead.

**NOTE** For correct orientation of the flex, align the 'O' on the flex with the 'O' on the PCB.  
 2. Orientate the Controlhead in the Back Housing, to suit the mounting position.  
 3. Press the Controlhead onto the Remote Back Housing until ALL tabs snap into place.

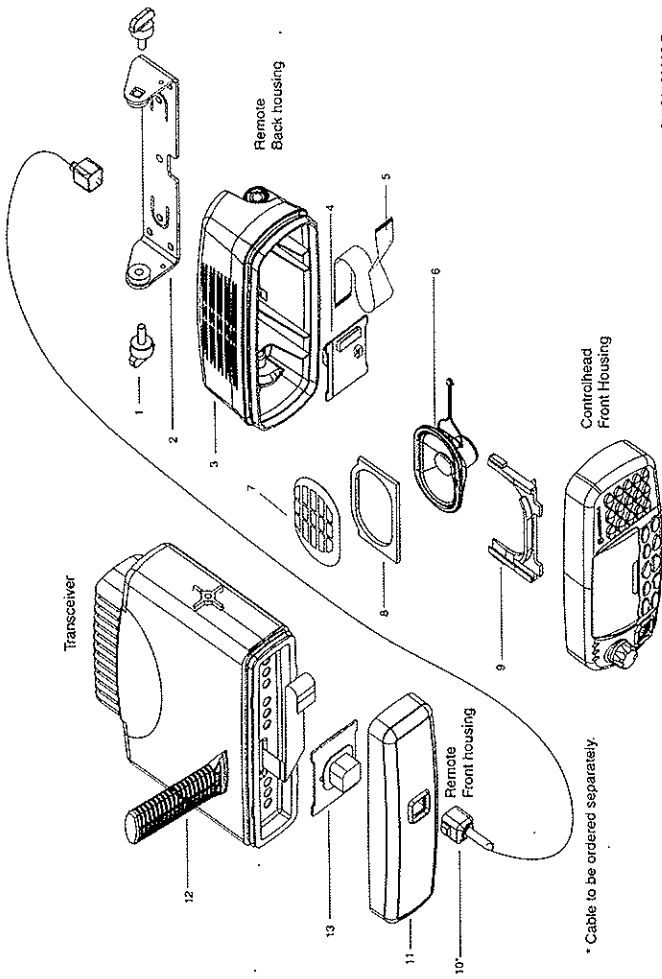

ZWGO130205-B.eps

Figure 1 Remote Front and Back Housings

### To Install the Remote Controlhead:

1. Position the Remote Mount Bracket in the desired location and mark the positions of the mounting holes. For maximum speaker volume ensure the area above the speaker is not inhibited.

**NOTE** When mounting on a vertical surface, an extra hole needs to be provided for the cable end connector.

2. Centrepunch the marked spots and drill 4mm holes at each spot, use the 4 corners where possible.
3. Fix the Remote Mount Bracket in position using the supplied screws.
4. Route the Remote Cable (Table 1) as required, feeding it through the bracket (a 20mm hole is required for the cable plug).
5. Push the cable plug into the Remote Front and Back Housing until it snaps into place.
6. Snap the assembly into the bracket.
7. Adjust the assembly as required then fix it in position with the wing screws supplied.

**Table 1: Associated Components**

| Item | Description   |
|------|---|
| 1    | Wingscrews  |
| 2    | Remote Bracket  |
| 3    | Remote Back Housing   |
| 4    | Remote PCB Front GLN7362B   |
| 5    | Flex (Part number 8486127B01)   |
| 6    | Speaker   |
| 7    | Grill, Speaker  |
| 8    | Pad, Speaker  |
| 9    | Clamp, Speaker  |
| 10   | Cable Kit 3M - RKN4077*<br>Cable Kit 5M - RKN4078*<br>Cable Kit 7M - RKN4079* |
| 11   | Remote Front Housing  |
| 12   | Dismantling Tool (Part number 6686119B01)                                     |
| 13   | Remote PCB Front GMLN4086A  |

\* Cable Kits to be ordered separately.

**Remote Mount PCB Flex Orientation:**

The twisted end of the flex is designed to go into the transceiver and the untwisted end into the Control head. The remote mount front housing replaces the control head so the untwisted end goes into the Remote PCB and the twist is untouched. The "O" on the flex faces the "O" on the Remote PCB. The remote mount back housing replaces the transceiver so the twisted end of the flex goes into the Remote PCB, the twist has to be removed in this case. The "O" on the flex lines up with the "O" on the Remote PCB.

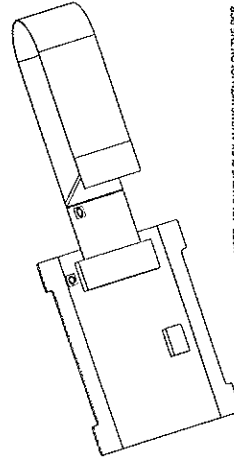

NOTE: "O" ON THE FLEX ALIGNS WITH "O" ON THE PCB  
ZWG0130511-Q.eps

**Figure 2 Remote Back Housing PCB with Flex**

**NOTE** The flex is not designed for continuous insertion , replace after several uses.

**NOTE** Specifications are subject to change without notice. Contact your Motorola dealer for the latest specifications.